

PROPOSAL APPLICATION FORM

CONTACT INFORMATION

NAME \_\_\_\_\_

ADDRESS \_\_\_\_\_

CITY \_\_\_\_\_ POSTAL CODE \_\_\_\_\_

PHONE \_\_\_\_\_ EMAIL \_\_\_\_\_

NAME OF ORGANIZATION OR COLLECTIVE (where applicable)  
\_\_\_\_\_

PROJECT TITLE \_\_\_\_\_

PROJECT SUMMARY (approx. 50 words)

[Empty rectangular box for project summary]

OCAD STUDENT: Y / N

(To be completed by OCAD STUDENTS)

DEPARTMENT: \_\_\_\_\_

YEAR OF STUDY: \_\_\_\_\_

STUDENT NUMBER: \_\_\_\_\_

WORK IN PROGRESS? Yes / No

PROPOSAL INTENDED FOR (please indicate preference):

- XSPACE MAIN GALLERY *For Group Exhibitions and Events*
- XBASE BASEMENT GALLERY *For Solo Exhibitions/ Works-in-Progress*
- XSPACE WINDOW SPACE *For Solo /Collaborative Exhibitions*
- OFF-SITE MEDIA SPACE *For Video and Interactive Artworks*
- WEB-BASED PROJECT *For Online and Web-based Artworks*

SIGNATURE \_\_\_\_\_ DATE \_\_\_\_ / \_\_\_\_ / \_\_\_\_



**PROJECT DESCRIPTION** *Approximately one page*

In your Project Description, please state whether you are proposing an exhibition or event, the media, and your interest in the space. The Project Description should give a clear and concrete impression of the work as well as its conceptual underpinnings.

For curators and group projects, please include a conceptual overview of the project and refer to the individual artists/designers works and how they relate to one and other.

For solo artists' proposals please provide a concise artist/designer statement.

**TECHNICAL DESCRIPTION** *Approximately one page*

For media, installation, or performance projects, please include a detailed Technical Description. Some technical information you may want to include:

- Space Requirements - list approximate size of works. For sculptural, performance, and installation works briefly describe the configuration of your work with approximate dimensions. (please refer to Main Gallery and XBASE floorplans)
- Format and Duration of piece *where applicable*

Please complete the following Equipment Checklist. Note that XPACE does not cover major technical and/or fabrication costs. The more complete the information supplied, the easier it is to evaluate the work and plan for a possible exhibition.

EQUIPMENT REQUIRED	XPACE has:	# Required
Digital Data Projector	3	
TV/LCD monitor (specify)	2	
DVD player/ CD Player	4	
PA Sound System	1	
Speakers	2 floor, 3 small	
Plinths		
Measurements	1. one	
1. 48"x29"x19"	2. three	
2. 16"x12"x45"	3. four	
3. 24"x24"x24"	4. one	
4. 18"x18"x18"		
Tables	2 small (3ftx3ft) 4 large (6ftx30")	
Shelf Unit	3 (42"x12"x6")	



58 Ossington Ave Toronto, ON M6J 2Y7 / 416 849 2864 / xspace.info

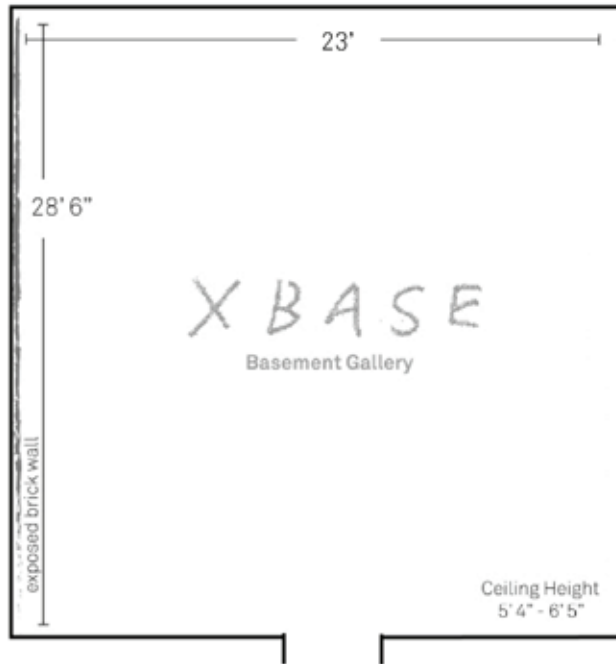
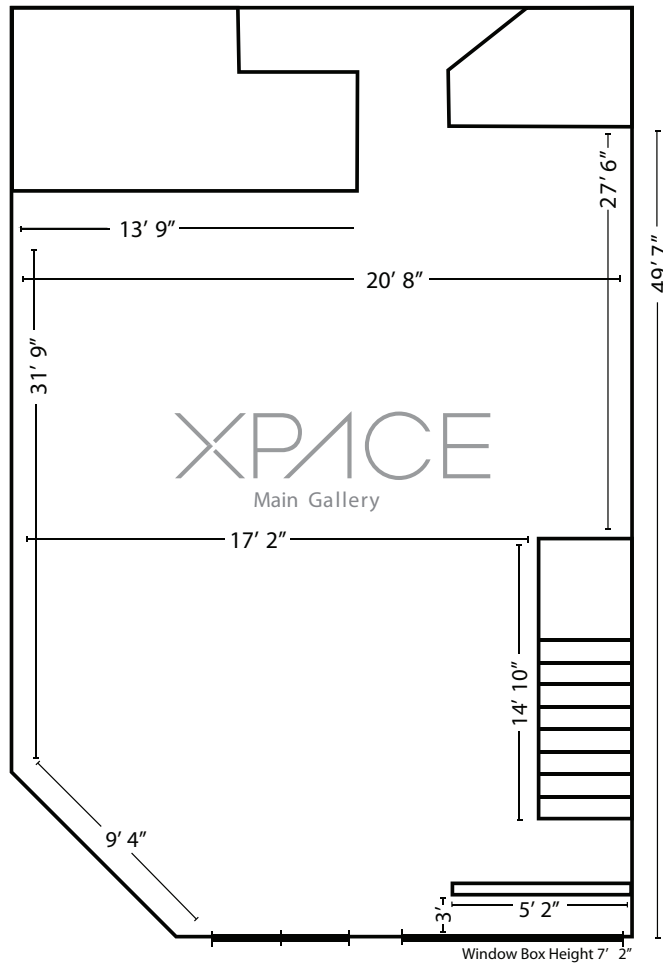

\*Please note that floorplans are not to scale.